

3

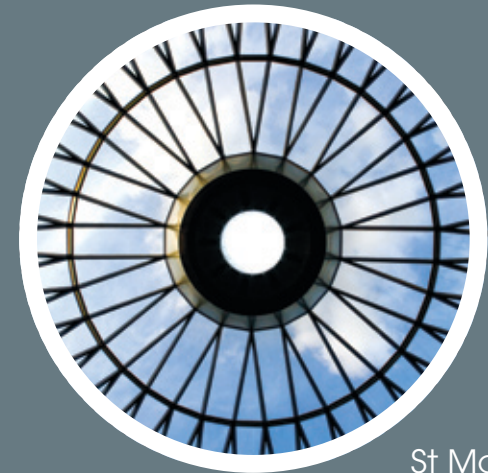

St Mary Axe EC3





St Mary Axe EC3

High quality fit out with excellent panoramic views of London.

Amenities

- High quality fit out
- Four pipe fan coil air conditioning
- Raised floors (150 mm)
- Suspended ceilings
- Dual power supply
- 6 passenger lifts
- Fully manned reception
- Restaurant and Bar (available for occupiers only)

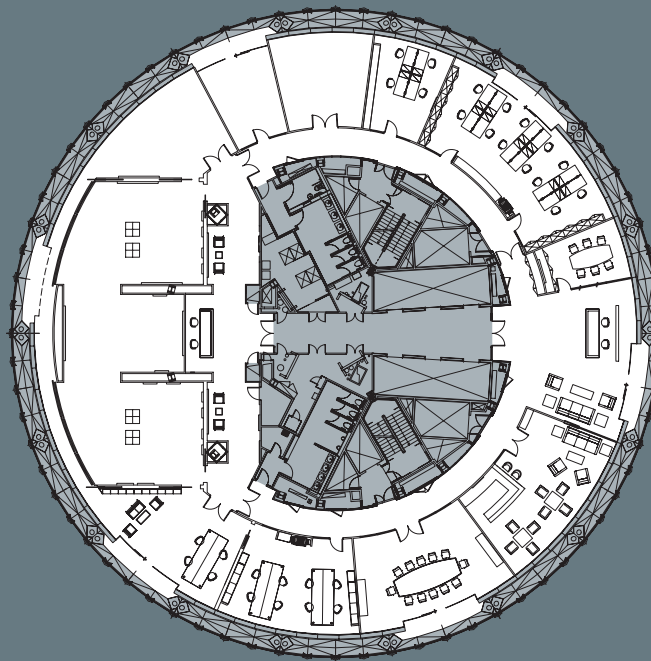

Availability

Entire 30th floor
Approx 11,892 sq ft (1104.8 sq m)

Indicative floor plan. Not to scale.





Description

30 St Mary's Axe is an iconic tower in the heart of the City of London. The property is instantly recognisable on the city's skyline and provides an outstanding environment in which to work. With a total of 34 office floors, this Norman Foster designed building has attracted occupiers which include, Swiss Re, Kirkland and Ellis, Axa Insurance and Allianz. In addition the property provides an exclusive restaurant and bar on the top two floors for occupiers within the building to take advantage of the 360° views across London and the home counties.



Exclusive restaurant on top floor



Peter Gray
peter.gray@knightfrank.com
020 7861 1304

Abby Smart
abby.smart@knightfrank.com
020 7861 1306



John Ostroumoff
john.ostroumoff@ostro-re.co.uk
020 7036 9980

David Dunsdon
david.dunsdon@ostro-re.co.uk
020 7036 9980

Important notice: 1.Particulars: These particulars are not an offer or contract, nor part of one. You should not rely on statements by Knight Frank LLP nor Ostroumoff in the particulars or by word of mouth or in writing ("information") as being factually accurate about the property, its condition or its value. Neither Knight Frank LLP nor Ostroumoff has any authority to make any representations about the property, and accordingly any information given is entirely without responsibility on the part of the agents, seller(s) or lessor(s). 2.Photos etc: The photographs show only certain parts of the property as they appeared at the time they were taken. Areas, measurements and distances given are approximate only. 3.Regulations etc: Any reference to alterations to, or use of, any part of the property does not mean that any necessary planning, building regulations or other consent has been obtained. A buyer or lessee must find out by inspection or in other ways that these matters have been properly dealt with and that all information is correct. 4.VAT: The VAT position relating to the property may change without notice. (Nov 2009) Designed by **citywise** | 020 7383 4000 | www.citywise.co.uk |